

# DISPENSERS

# SUZZARABLU DRUM



**EN.** The dispensing group has been provided with a base that can be moved from one drum to another.

The group is composed by: a stainless steel base for the drum, pump, manual nozzle, delivery hose (6 m), suction hose.

**RU.** Узел подачи оснащен основанием, которое можно просто установить и снять с одной бочки на другую. Узел состоит из: опорного листа из нержавеющей стали для бочки, электронасоса, ручного пистолета, напорной трубы (6 м), всасывающей трубы.

**DE.** Die Abgabereinheit verfügt über eine leicht anzubringende und von einem zum anderen Fass versetzbare Grundplatte. Die Einheit besteht aus: rostfreier Grundplatte für das Fass, Elektropumpe, manueller Zapfpistole, Druckschlauch (6 m), Saugschlauch.

## PERFORMANCE

- Duty cycle 20 min

- Рабочий цикл 20 мин.

- Arbeitszyklus 20 min



Not included

## PRODUCTS' RANGE WEIGHT AND PACKAGING

| Code             | Weight |      | Packaging   |                |         |
|------------------|--------|------|-------------|----------------|---------|
|                  | kg     | lbs  | mm          | inch           | pcs/box |
| <b>F0020135D</b> | 16     | 35,3 | 480x370x265 | 18,3X14,6X10,4 | 1       |
| <b>F00201D5B</b> | 16     | 35,3 | 480x370x265 | 18,3X14,6X10,4 | 1       |
| <b>F00201E5B</b> | 16     | 35,3 | 480x370x265 | 18,3X14,6X10,4 | 1       |

**Flow-rate**

up to  
**32** l/min  
(up to 8,3 gpm)



DISPENSERS

PUMPS

METERS

NOZZLE METERS

NOZZLE

SPECIAL EQUIPMENTS

FLUID MONITORING

ACCESSORIES

FILTERING



SUZZARABLU DRUM

AVAILABLE WITH:



SB325  
AUTOMATIC NOZZLE

AVAILABLE WITH:



SB325 METER  
AUTOMATIC NOZZLE

**INCLUDED**

Manual nozzle



SEC connection



Dip tube

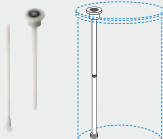

**FEATURES**

AC pump



On/Off switch



Automatic nozzle



Code F15606000

**PRODUCTS' RANGE** TECHNICAL DATA

| Code      | Description                          | Fluids type | Flow-rate |     | Voltage  |         |            | Meter mod. | Nozzle type | Suction | Hose      |        | On/Off switch |     |
|-----------|--------------------------------------|-------------|-----------|-----|----------|---------|------------|------------|-------------|---------|-----------|--------|---------------|-----|
|           |                                      |             | l/min     | gpm | AC V./Hz | DC Volt | Power Watt |            |             |         | Amp. max. | length |               | Ø   |
| F0020135D | SUZZARABLU DRUM                      | U           | 32        | 8,5 | 230/50   |         | 400        | 495        | NO          | Man.    | SEC       | 6 m    | 3/4"          | YES |
| F00201D5B | SUZZARABLU DRUM + SB325 nozzle       | U           | 32        | 8,5 | 230/50   |         | 400        | 495        | NO          | SB325   | SEC       | 6 m    | 3/4"          | YES |
| F00201E5B | SUZZARABLU DRUM + SB325 nozzle meter | U           | 32        | 8,5 | 230/50   |         | 400        | 495        | YES         | SB325   | SEC       | 6 m    | 3/4"          | YES |